



EN

EVAPORATIVE AIR COOLER

POLIFEMO ZEUS



OPERATING INSTRUCTIONS

Read the instructions carefully before operating the appliance or carrying out maintenance operations. Observe all the safety instructions; failure to observe the instructions may lead to accidents and/or damage. Keep these instructions in a safe place for future reference.

GENERAL SAFETY INFORMATION

- Only use this appliance as described in this manual. Any other use not recommended by the manufacturer may cause fire, electric shock or injury to people.
- Do not use this appliance outdoors, this product is for indoor use only.
- Make sure that the type of mains power complies with the electrical requirements of the appliance (220-240V~/50 Hz).
- This appliance can be used by children aged from 8 years and above and people with reduced physical, sensory or mental capabilities or lack of experience and knowledge if they have been given supervision or instruction concerning use of the appliance in a safe way and understand the hazards involved.
- Children shall not play with the appliance.
- Cleaning and user maintenance shall not be made by children without supervision.
- This product is not a toy. Children should be adequately supervised to ensure that they do not play with the appliance.
- Disconnect the mains power when the appliance is not used or for cleaning operations.
- Unplug the appliance during filling and cleaning.
- Do not ingest battery, Chemical Burn Hazard.
- This product contains a coin/button cell battery. If the coin/button cell battery is swallowed, it can cause severe internal burns in just 2 hours and can lead to death.
- Keep new and used batteries away from children.
- If the battery compartment does not close securely, stop using the product and keep it away from children.
- If you think batteries might have been swallowed or placed inside any part of the body, seek immediate medical attention.
- The batteries contain materials, which are hazardous to the environment; they must be removed from the appliance before it is scrapped and that they are disposed of safely.
- Be aware that high humidity levels may encourage the growth of biological organisms in the environment.
- Do not permit the area around the humidifier to become damp or wet. If dampness occurs, turn the output of the humidifier down. If the humidifier output volume cannot be turned down, use the

humidifier intermittently. Do not allow absorbent materials, such as carpeting, curtains, drapes, or tablecloths, to become damp.

- Never leave water in the water tank when the appliance is not in use.
- Empty and clean the humidifier before storage. Clean the humidifier before next use.

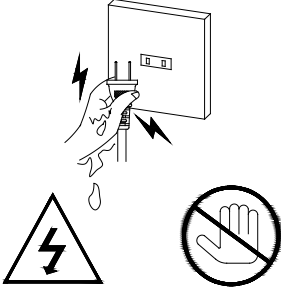
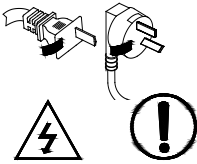
<p>In the event of any problems, switch off the appliance immediately, do not attempt to repair it, and take it to your local After-Sales Service Centre. Do not remove or replace individual parts, as this could affect product safety.</p>  <p>Do not disassemble the appliance!</p>	<p>Do not touch the power cord with wet or damp hands; risk of electric shock.</p>  <p>Warning!!! Do not touch Risk of electric shock!</p>
<p>Do not use the appliance near flammable or explosive gases.</p>	<p>Place the device at a distance of at least 1 meter from TV and radio to avoid interference.</p>
<p>Do not use the appliance if the cord or plug is damaged. Do not attempt to change the power cord yourself. If the power cord is damaged, it must be replaced by the manufacturer, dealer or a similarly qualified person so as to avoid any safety risks.</p>  <p>Warning!!! Do not touch Risk of electric shock!</p>	<p>Do not bend or stand heavy objects on the power cord.</p> <p>Do not use extension cord.</p>
<p>Turn the switch off and unplug before carrying out any maintenance work or moving the appliance. Always unplug from the socket when the appliance is not in use.</p>	<p>To disconnect the appliance, press ON/OFF button and unplug from the socket. Only pull on the plug. Do not pull the cord. Otherwise the cable may be damaged or leaks, etc. may occur.</p>
<p>Do not place the appliance under a power socket, do not use the appliance in a bathroom or near a swimming pool.</p>	<p>Do not block the air inlet and outlet grille.</p> <p>Do not pull the rotary blade, this can damage the synchronous motor.</p>
<p>Do not pour water over the product: risk of short-circuits and damage to the product.</p>	<p>Do not leave the airflow directed towards children for long periods of time: it is not good for their health.</p>
<p>Keep away the appliance from curtains, carpets, furniture to prevent them from absorbing the humidity emitted by the unit.</p>	<p>Do not expose the unit to direct sunlight.</p>

DESCRIPTION OF PARTS

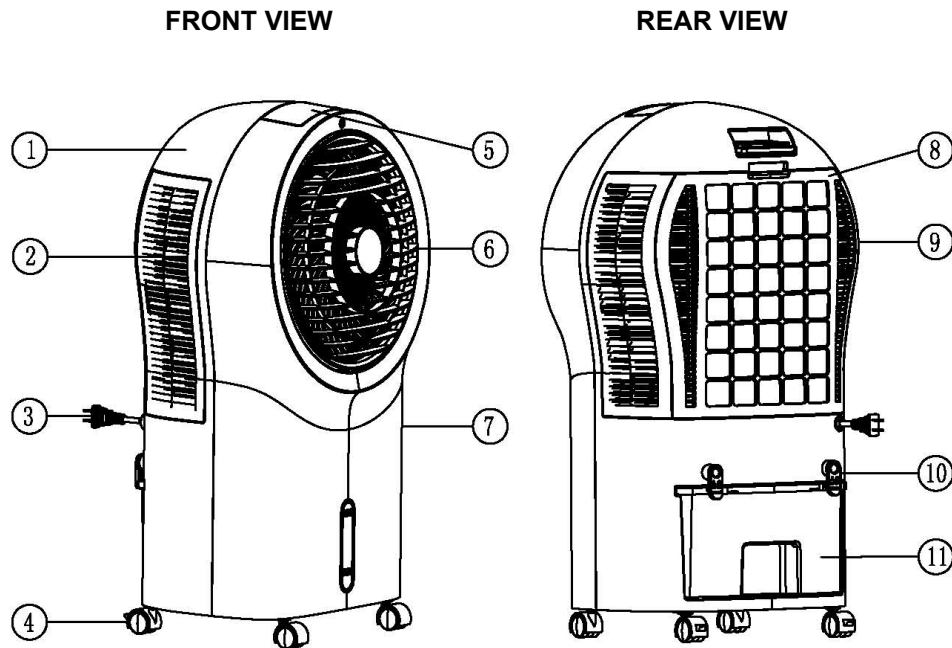

1. Rear panel
2. Side air filter
3. Power cord
4. Castors
5. Control panel
6. Rotating blades

7. Front panel
8. Air filter and evaporative panel
9. Side air filter
10. Cable reel
11. Water tank

HOW TO USE THE APPLIANCE

The device does not require installation.

Place the unit on a flat and stable surface and connect the power cable to an appropriate power socket (220-240V ~): the appliance can be started by pressing the ON / OFF button: the unit goes into stand-by -by, it emits two beeps and the white LED located above the ON / OFF button is always on during operation.

To move the device use the handle on the back. Do not use this cooler in an area with high humidity, rich in dust or with a temperature above 40 ° C.

This product can be used, **with 3 modes (Normal, Natural, and Sleep) and 3 possible ventilation speeds (low, medium, high), both as a fan and as a cooler / humidifier**: in this case, the rear tank must be filled with **demineralized water**, without exceeding the maximum limit indicated on the front of the appliance through a transparent window. When the water level is below the minimum level, the water pump cannot draw water from the tank, so it stops or does not start. An acoustic signal and a light alarm will sound (the Cool / Humidifier button LED lights up), to remind you that there is not enough water.

The unit does not stop working, only the water pump stops working, then the "cooling / humidification" function is stopped, while the ventilation continues.

At the end of use, remove the internal tank from its seat and always empty it.

The fan sucks air from the environment and passes it through the anti-dust filter and the evaporative panel, which is kept constantly humidified thanks to a system that draws water from the tank and sprays it on the panel. The incoming hot air evaporates part of the water which is soaked in the panel and is returned to a cooler environment, producing a decrease in the perceived temperature.

CONTROL PANEL

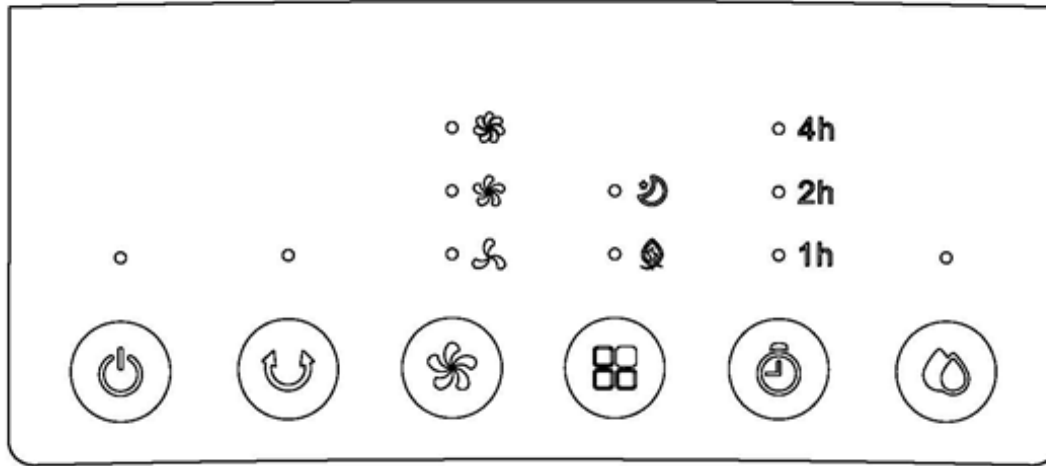

ON/OFF BUTTON



Press this button on the control panel to turn the appliance on or off.

After pressing the button, the unit will emit two beeps, and will go into stand-by mode; press the ON / OFF button again and the unit will operate in Normal mode, in low ventilation for 3 seconds, then it will switch to medium ventilation speed: this only when the unit is turned on for the first time. The corresponding LED will light up on the control panel.

On the other hand, when it is not the first use, by pressing this button the second time the unit will first operate at medium ventilation speed, and then switch to the previously set ventilation speed before switching off.

In stand-by mode it is only possible to turn the appliance on or off, all other functions are not operational.

With the unit running, press the ON / OFF button to restore the stand-by mode.

SWING BUTTON





With the unit on, press this button to activate the left-right oscillation of the air delivery grille, the corresponding LED on the control panel will turn on. To turn off the swing function, press this button again

SPEED BUTTON



With the unit on, press this button to select the desired fan speed in the following sequence: low -> medium -> high. The corresponding LEDs will light up on the control panel as follows:

low fan speed  medium fan speed  high fan speed 

MODE BUTTON



When the unit is turned on it works in Normal mode.

Press this button to select the desired operating mode in the following sequence:

Normal -> Natural -> Sleep

- **Normal Mode:** the unit works according to a pre-defined program; the corresponding LED on the control panel



is It's possible to select the desired fan speed.

- **Natural Mode:** the unit works by alternating periods at low, medium or high speed according to a pre-defined

program and accordingly the selected fan speed; in this mode the corresponding LED on the control panel is 

Below is the operating diagram of the Natural mode according to the fan speed set:

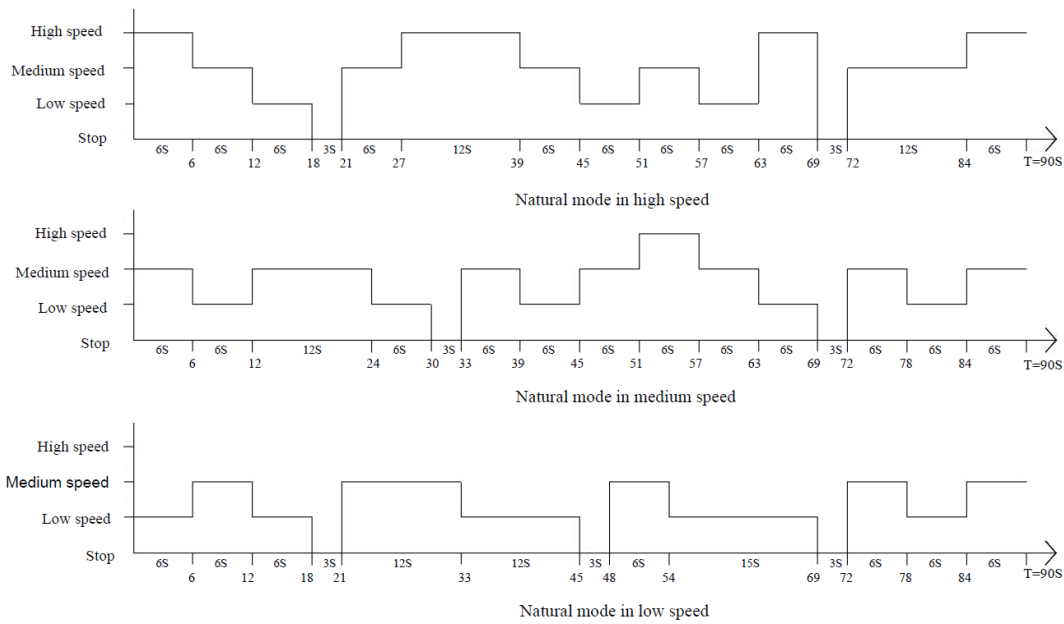

- **Modalità Sleep:** the unit works alternating periods at low, medium or high speed according to a pre-defined program

and accordingly the selected fan speed; in this mode, the corresponding LED on the control panel is 

High speed and sleeping mode on: The unit operates at high ventilation speed for 30 minutes, then switches to medium ventilation speed for 30 minutes, then continues to operate at low ventilation speed.

Medium speed and sleeping mode on: The unit operates at medium ventilation speed for 30 minutes, then continues to operate at low ventilation speed.

Low speed and sleeping mode on: The unit works constantly in low ventilation speed. The corresponding LEDs will light up according to the operational ventilation speed

TIMER BUTTON

With the unit on, press this button to select the appliance operation interval.

Press the ON / OFF button, the LED "1H" (1 hour) lights up, press this button repeatedly to select the interval: Led_1H → Led_2H → Led_1H + 2H → Led_4H → Led_1H + 4H → Led_2H + 4H → Led_1H + 2H + 4H → all off → 1H, up to a maximum of 7 hours.

When the selected interval is reached, the unit turns off and goes into stand by mode.

COOL / HUMIDIFIER BUTTON

With the unit on, press this button to activate the COOL (cooling) / Humidifier (humidification) function.

The corresponding LED on the control panel lights up. To deactivate the function, press this button again.

DETECTION FUNCTION and RAPID DETECTION OF THE WATER LEVEL IN THE TANK

When the unit is started in cooling mode, it generally takes 50 seconds to detect any lack of water in the tank: at this point an acoustic signal is emitted and a light alarm indicates the lack of water; the water pump stops and therefore also the cooling function.

The "quick water level detection function" takes only 8 seconds: after switching on, within 10 seconds, press and hold the "cooling / humidification" button for 3 seconds; the unit is able to immediately detect the presence of water in the tank. If there is not enough water, it signals the lack of water with a 5-second beep.

MEMORY FUNCTION

With the power cord connected, when you turn on the unit by pressing the ON / OFF button, it will start to work with the last settings selected before turning off, with the exception of the Timer and Sleep functions, which cannot be stored. When the unit is switched on again, it will operate at medium ventilation speed, and then switch after 3 seconds to the ventilation mode selected before switching off.

PARTIAL DISPLAY LIGHTING DEACTIVATION FUNCTION

If no selection is made on the control panel, after 1 minute the intensity of the display lighting is reduced to 33%: by touching any key, the LEDs return to full light intensity.

REMOTE CONTROL

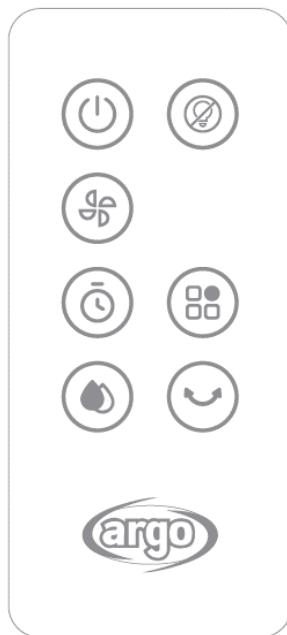

The buttons on the remote control correspond to the functions on the control panel. On the remote control there is also the button that allows the deactivation of the LEDs on the control panel of the appliance.

HOW TO INSERT / REMOVE THE REMOTE CONTROL BATTERIES (refer to the diagram below)

Open the battery cover on the back of the remote control (press and pull the cover).

Place the battery inside the cover, making sure the polarity is correct. Slot the cover back into position on the remote control.

Use Lithium/Manganese button cells, model no. CR2032 -3 V, compliant with Battery Directive no. 2006/66/EC and modification of Directive 2013/56/EU (supplied with the remote control)

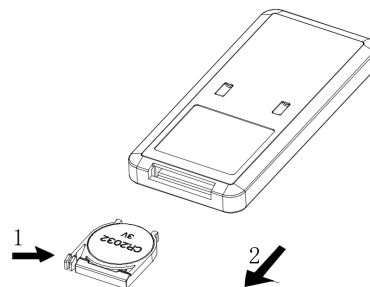



INFORMATION FOR CORRECT DISPOSAL OF THE PRODUCT IN ACCORDANCE WITH EUROPEAN DIRECTIVE 2006/66/EC modifications former Directive 2013/56/EU

Please replace the battery when its electrical charge has been exhausted: at the end of its useful life, it must not be disposed of together with unsorted waste. It must be delivered to appropriate separated waste disposal plants or to dealers that provide a similar service. Separate waste disposal of batteries prevents potential negative effects on the environment and human health resulting from inadequate disposal, and also allows the materials from which it is made to be recovered and recycled in order to achieve significant savings in terms of energy and resources. The separate disposal obligation is underlined by the crossed-out dustbin symbol appearing on the battery. Illegal disposal of the product by the user shall result in the application of administrative sanctions as defined by current regulations.

FILLING THE WATER TANK

THE TANK MUST BE FILLED WITH DEMINERALIZED WATER FOR THE APPLIANCE TO OPERATE IN COOLER/HUMIDIFIER MODE.

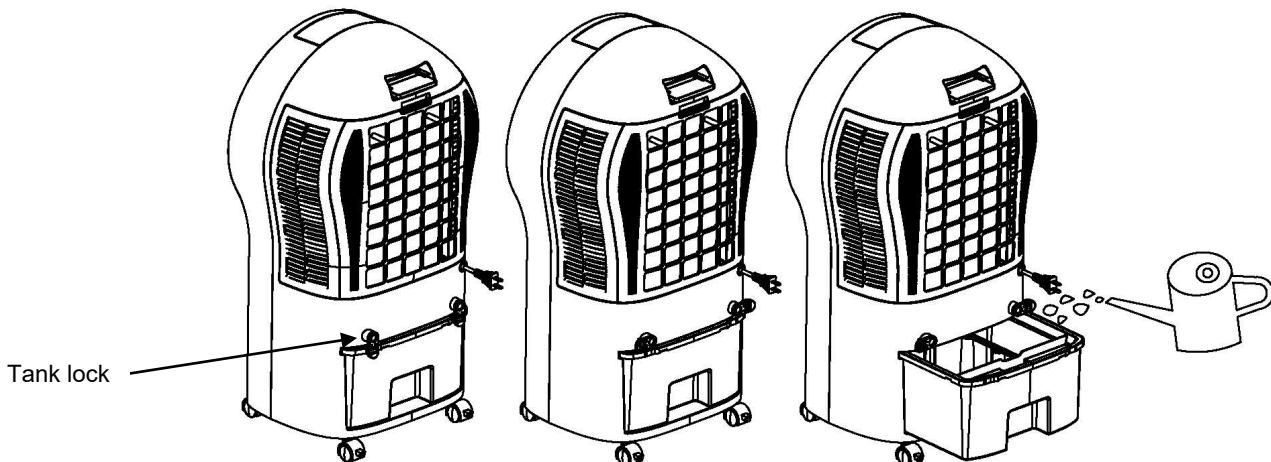

Before turning on the appliance, remove the two lateral tank locks by turning them, and extract the tank located in the back of the appliance. Add demineralized water directly to the water tank. Fill the tank up to the maximum limit indicated, it will be possible to view the water level through a transparent window, located on the front panel of the unit. Once the tank has been filled, put it back in its place and reposition the tank locks.

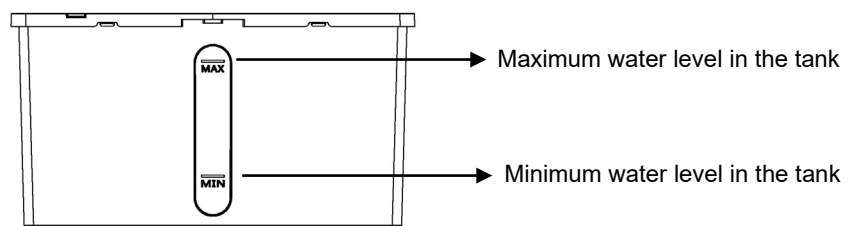

If you want to keep the temperature of the water in the tank below the ambient temperature for a long time, in order to favor cooling in the hottest season, add one of two tablets of synthetic ice supplied to the water in the tank, after having left it in the freezer for the time necessary for its complete consolidation. Ice absorbs heat from water.

Continuous use of ice is recommended to optimize the cooling capacity.

It is possible that the first time you use it, you will notice a perfume or the water takes on a particular color: there are no health risks.

MAINTENANCE AND STORAGE

WARNING: ALWAYS UNPLUG THE APPLIANCE BEFORE CLEANING OR MAINTENANCE PROCEDURES. IMPORTANT: DO NOT SUBMERGE THE PRODUCT IN WATER

Cleaning the outside surface of the appliance

Use a soft cloth to remove any dust from the product.

If this is not enough, use a soft cloth dampened with water and a mild detergent at a temperature not exceeding 50°C. Let the appliance dry completely before using it.

Do not use corrosive detergents or solvents such as petrol. Do not wash the appliance with water. Do not use oils, chemical substances or other items that may damage the surface to clean it.

Use a vacuum cleaner to remove dust from the air inlet/outlet grilles.

Cleaning the dust filters, the honeycomb panel and the water tank

Clean the dust filters frequently, at least once a month.

Gently remove the filter assembly on the rear side of the appliance and the side air filters, then extract the honeycomb panel, as shown in the drawing below.

Clean the dust filters with a soft brush or vacuum cleaner and wash it in water with a neutral detergent.

Soak the honeycomb filter in detergent for a few minutes, then wash it and perfectly dry it.

Allow the air filters and honeycomb filters to dry completely after washing.

After removing the water tank, clean it with a cloth soaked in detergent, then rinse it with water and remove any residual water.

After cleaning, reinstall the components.

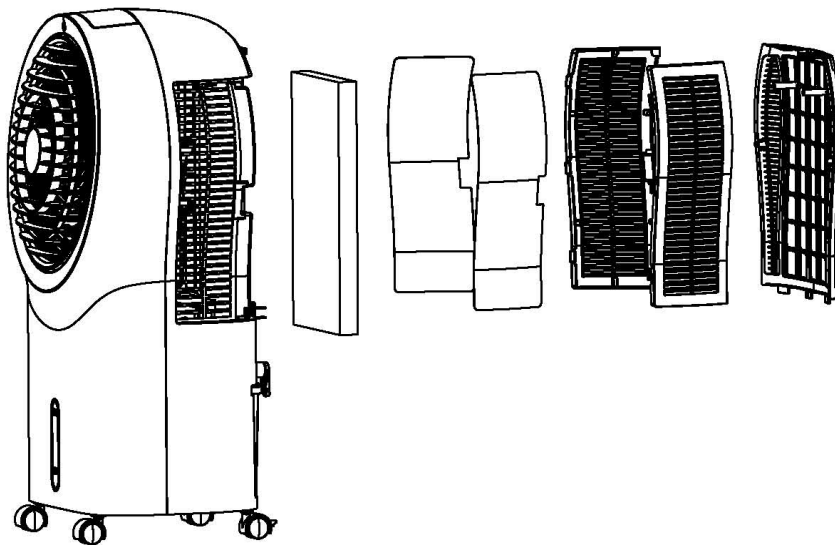

STORAGE

If the appliance is not used for prolonged periods, disconnect the power cord and store the appliance with this manual in its original packaging, in a cool and dry place.

Before packaging, the honeycomb filter and dust filters should be dry, and there is no water in the tank.

In case of prolonged non-use, remove the remote control battery before storing it.



INFORMATION FOR THE CORRECT DISPOSAL OF THE PRODUCT IN ACCORDANCE WITH EUROPEAN DIRECTIVE 2012/19/EU

This appliance may not be scrapped with domestic waste at the end of its life cycle. We call your attention to the crucial role played by the consumer in the re-use, recycling and other forms of recovery of such waste.

The appliance must be scrapped by a sorted waste disposal centre or by returning it to the retailer (no charge is levied for this service), when you purchase a new equivalent appliance.

Sorted disposal of electric and electronic equipment prevents the negative effects on the environment and human health resulting from improper scrapping, and also allows the materials from which it is made to be recovered and recycled, with significant savings in terms of energy and resources. The sorted disposal requirement is indicated by the crossed waste bin label affixed to the appliance.



improve your life

www.argoclima.com