



EN

DC DESK AND STAND FAN

IPNO



OPERATING INSTRUCTIONS

Read the instructions carefully before operating the appliance or carrying out maintenance operations. Observe all the safety instructions; failure to observe the instructions may lead to accidents and/or damage. Keep these instructions in a safe place for future reference.

GENERAL SAFETY INFORMATION

- Use this fan only as outlined in this manual. Any other use not recommended by the manufacturer may cause fire, electric shock or injury to people.
- Ensure that the mains power complies with the voltage specified on the fan's data plate (220-240V~/50Hz).
- This product is not a toy. Children should be adequately supervised to ensure that they do not play with the appliance.
- Children must not play with the product.
- This appliance cannot be used by children aged not less than 8 years and by people with reduced physical, sensory or mental abilities, or without the necessary experience and knowledge, unless they have been adequately supervised and instructed concerning use of the appliance by a person responsible for their safety.
- Cleaning and maintenance to be carried out by the user must not be carried out by children without supervision.
- Do not restrict the air inlet and outlet grilles.
- Disconnect the mains power when the appliance is not used or for cleaning operations.
- Do not place anything on the appliance, use the appliance to dry clothing.
- Avoid placing fingers or foreign objects in the air inlet/outlet grilles, as this may lead to electric shock or fire and may damage the appliance.
- To avoid the risk of fire, do not block the grilles or tamper with them in any way while the fan operates.
- Do not use the appliance if the cord or plug are damaged. If the power supply cord is damaged, it must be replaced by the manufacturer, dealer or a similarly qualified person so as to avoid any safety risks.

- Do not operate the appliance if it has fallen from a height or has suffered damage in any way. Contact qualified technical personnel to examine the appliance or perform any electrical or mechanical repairs.
- The most common cause of overheating is the build-up of dust in the appliance. Remove dust deposits by unplugging the appliance and cleaning the air outlets and grilles with the aid of a vacuum cleaner.
- Do not use abrasive detergents for cleaning this appliance. Clean the appliance with the aid of a damp (not wet) cloth rinsed in hot soapy water. Always remove the plug from the mains socket before cleaning.
- To disconnect the fan, push the switch to OFF and remove the plug from the socket. Pull on the plug only. Avoid pulling on the cord when disconnecting the fan.
- Do not place any objects on the cord and do not bend it.
- It is not advisable to use extension cords, as these may overheat and cause the risk of fire. Do not use a single extension cord to operate multiple appliances.
- Do not immerse the cord, plug or any other element of the appliance in water or other liquids.
- Do not touch the plug with wet hands.
- Do not place the fan above or near another heat source.
- Do not connect the appliance to the mains power before it has been properly assembled and positioned.
- Do not run the cord under carpets. Do not cover the cord with blankets, carpets or similar materials. Place the cord far away from busy areas or where it cannot be accidentally pulled-out.
- Keep fire material such as furniture, cushions, blankets, papers, clothes, curtains and more at a distance of 1 m from the front from the sides and back.
- Do not use the fan in dusty environments or in the presence of flammable vapors (for example in a laboratory or garage)

- A fan has inside parts that generate arcs or sparks. It must not be used in areas that could be dangerous, such as areas at risk of fire, explosions loaded with chemicals or atmospheres full of humidity.
- Do not use the fan in the immediate vicinity of bathtubs, showers, washbasins and swimming pools.
- Use the fan in a well-ventilated area
- Do not position the fan below a socket outlet.
- Do not operate the appliance outdoors.

WARNING: DO NOT DEPEND ON THE ON/OFF BUTTON SWITCH AS THE SOLE MEANS OF DISCONNECTING POWER. WHEN SERVICING OR MOVING THE FAN, ALWAYS UNPLUG THE POWER CORD.

- A fan has hot and arcing or sparkling parts inside. It must not be used in potentially dangerous locations such as flammable, explosive, chemical-laden or wet atmosphere.
- Do not place the fan on soft surfaces, like a bed, where openings may become blocked. Always place the fan on a stable, flat, level surface when operating, to avoid the chance of the overturning. Locate the power cord so the fan or other objects are not resting on it
- Always unplug the fan when not in use
- In order to avoid accidents turn unit off if unattended
- In the event of any problems (abnormal noise or a strange smell) switch off the appliance immediately, do not attempt to repair it and take it to your local after sales service.
- To move the product use the handle on the back of the product

DESCRIPTION OF PARTS

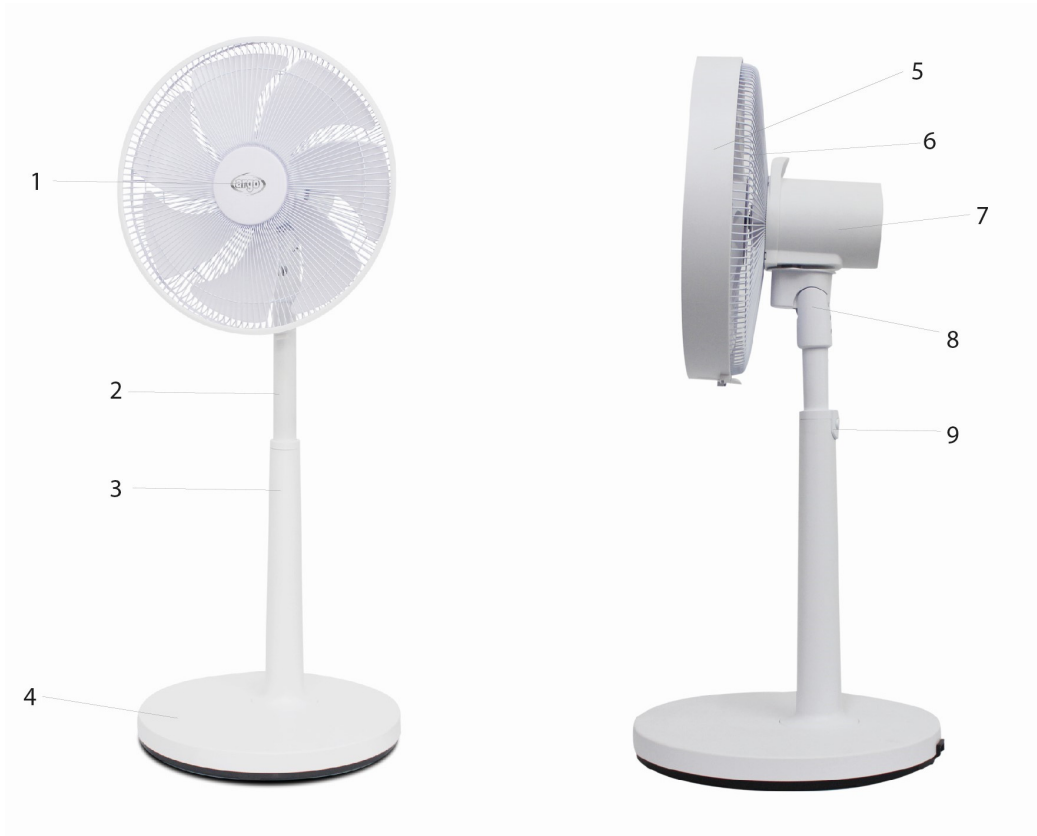

1. Grill cover plate
2. Inner column
3. Outer column
4. Fan base
5. Grill hoop
6. Rear grill
7. Rear motor cover
8. Flexible Rack
9. Height adjustable button

ASSEMBLY INSTRUCTIONS

Open the box and remove the parts of the appliance.

Put the outer column into the base and put the lock nut under the base, rotating it in a clockwise direction and ensure it is fixed

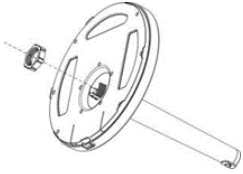

Assembly diagram of the parts

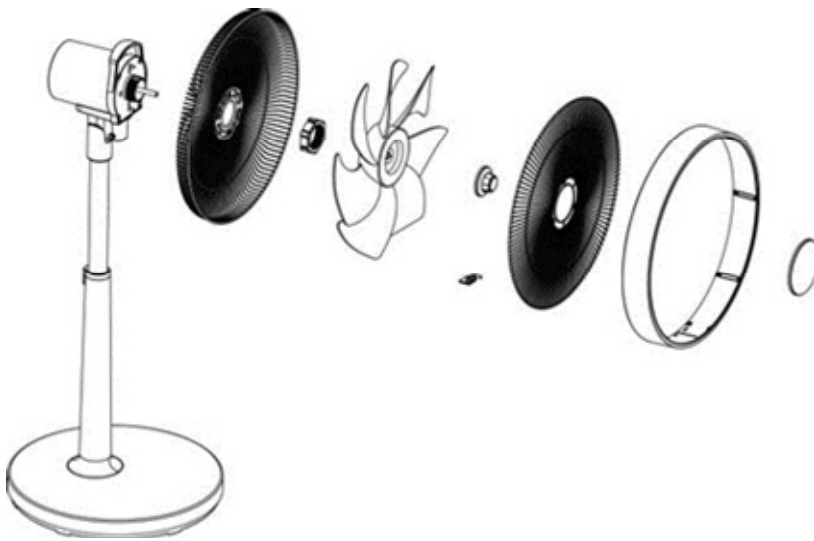

1

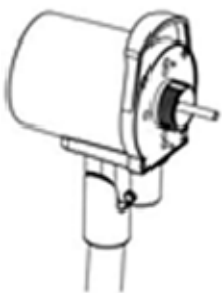

Motor shaft.

2



Insert the rear grill on the motor shaft in the proper position.
Screw the nut in order to fasten the rear grill firmly.

3



Set the blade on the motor shaft.

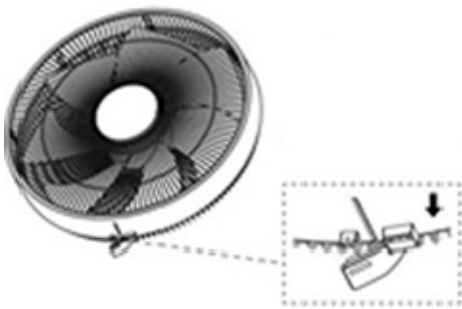

Tighten the nut on the motor shaft

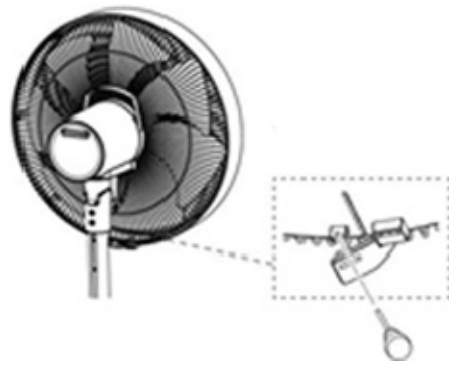

With the aid of the ring join front and rear grill and tighten the screw on the ring

HOW TO USE THE APPLIANCE

CONTROL PANEL AND AVAILABLE FUNCTIONS



Plug the power cord into an appropriate power outlet (220-240V~/50HZ).

Symbol  : **Mode selection**

Pressing 1 time: to select Timer: press + and – to set the ventilation time of product



Pressing 2 times: the unit starts working in Natural mode: press + and – to select ventilation speed

Pressing 3 times: the unit starts working in Sleep mode: press + and – to select ventilation speed

Pressing 4 times: return on Normal mode

ON/OFF Button  : After power on the red light on  shows that the product it's in stand-by. Press this button to start the ventilation, it will be in Normal mode with 6 speed ventilation.

Meanwhile lights on buttons + and – are on, press them to set the desired speed ventilation. Press again  and fan will turn off.

Timer Turn Off Button  : After power on, press this button for Timer Off function (Timer Off Light will be on). Press + and – to set the timer from  to 10 hours.

Timer Turn ON Button  : When fa it's in stand-by press this button to set the timer from 1 to 10 hours.

Ventilation Mode: this fan has 3 ventilation modes Normal, Natural and Sleep.

Symbol  : **Mode selection**

Pressing 1 time: to select Timer: press + and – to set the ventilation time of product

Pressing 2 times: the unit starts working in Natural mode: press + and – to select ventilation speed

Pressing 3 times: the unit starts working in Sleep mode: press + and – to select ventilation speed

Pressing 4 times: return on Normal mode

- **Normal:** The fan for the first time start in Normal mode, press + and – to set the ventilation speed from 1 to 9 based on desired speed level.

To switch from Normal mode to the next mode press again 

-**Natural:** It's the next mode after Normal (LED light it's on the panel) press + and – to select the ventilation speed from F1 to F9

To switch from Natural mode to the next mode press again 

- **Sleep:** it's the next mode after Natural (LED light it's on the panel) press + and – to select the ventilation speed from P1 to P9

Horizontal oscillation button  : After power on press this button to start the oscillation button. Press this button again to turn off the oscillation.

Auto Panel Turn off function: when there is any operation on fan automatically within 1 minute the panel turns off, only red LED on ON/OFF button it's on. Press any button on the panel to make the panel reappear.

Auto Turn off function: when there is no more operation (as well as no remote control commands) the fan will be shut down automatically after 12 hours.

Remote control function: The buttons on the remote control are corresponding with the main body functions.

Memory function: in case of black-out or power supply disconnection, when the unit restarts keep the previous settings as set.

REMOTE CONTROL

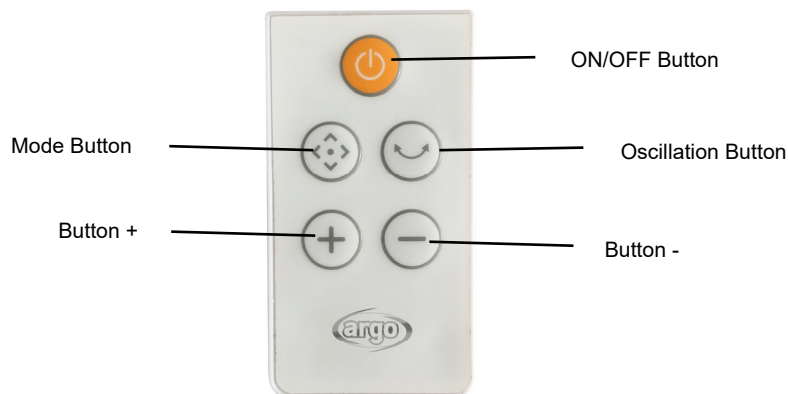

HOW TO INSERT / REMOVE THE REMOTE CONTROL BATTERY (refer to the diagram)

Open the battery cover on the back of the remote control (press and pull the cover with the side hook).

Place the battery inside the cover, making sure the polarity is correct.

Slot the cover back into position on the remote control.

Use no.1 button Lithium/Manganese battery model CR2025-3V, compliant with Battery Directive no. 2006/66/EC amendments Directive 56/2013/EC.

Remove the battery when not using the remote control for a long period of time.

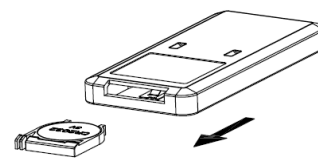

INFORMATION FOR CORRECT DISPOSAL OF THE BATTERIES IN ACCORDANCE WITH EUROPEAN DIRECTIVE 2006/66/EC amendments Directive 2013/56/EC

Please replace the battery when its electrical charge has been exhausted: at the end of its useful life, it must not be disposed of together with unsorted waste. It must be delivered to appropriate separated waste disposal plants or to dealers that provide a similar service. Separate waste disposal of batteries prevents potential negative effects on the environment and human health resulting from inadequate disposal, and also allows the materials from which it is made to be recovered and recycled in order to achieve significant savings in terms of energy and resources. The separate disposal obligation is underlined by the crossed-out dustbin symbol appearing on the battery. Illegal disposal of the product by the user shall result in the application of administrative sanctions as defined by current regulations.

MAINTENANCE AND STORAGE

**ALWAYS UNPLUG THE APPLIANCE BEFORE CLEANING OR MAINTENANCE.
IMPORTANT: DO NOT SUBMERGE THE FAN IN WATER.**

Cleaning the outside surface of the appliance

Turn the switch off and unplug before carrying out any maintenance work or moving the appliance.

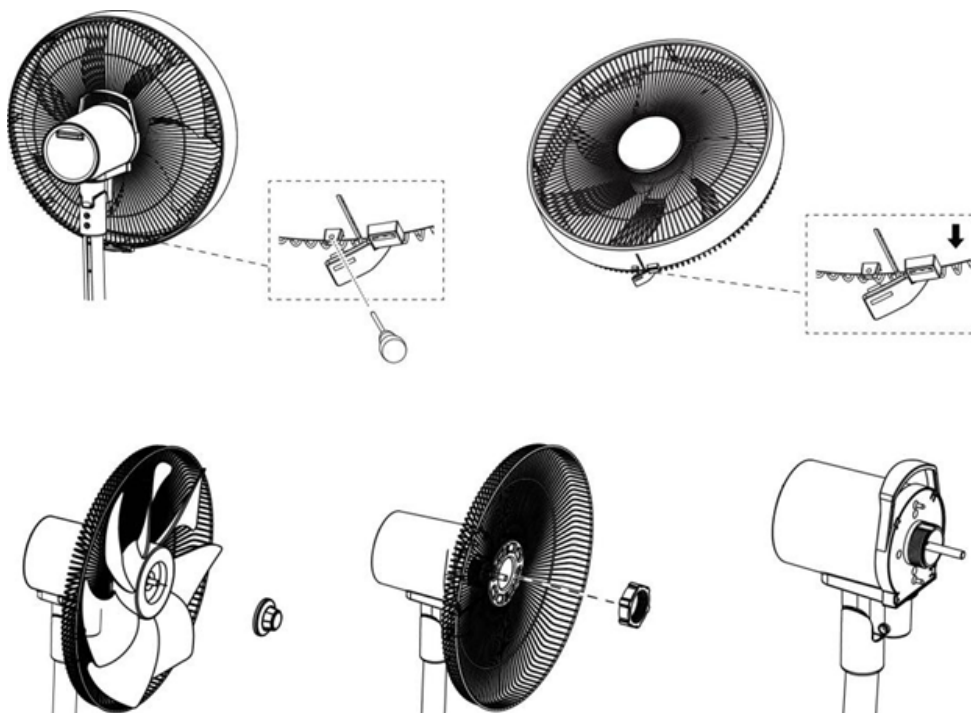

Remove the front grille (there is a clip behind the grille) then remove the fan lock and gently pull the fan out. Unscrew the rear grill and remove the grill.

Put the grids in water with a liquid detergent for about ten minutes, brush and dry with a dry cloth.

Allow the appliance to dry completely before using it.

Do not apply corrosive detergents or solvents such as petrol. Do not wash the appliance with water. Do not use oils, chemicals or other objects that could damage the surface during cleaning.

STORAGE

If the appliance is not used for prolonged periods, disconnect the power cord and store the appliance with this manual in its original packaging, in a cool and dry place. Remove the battery from remote control.



INFORMATION FOR THE CORRECT DISPOSAL OF THE PRODUCT IN ACCORDANCE WITH EUROPEAN DIRECTIVE 2012/19/EU

This appliance may not be scrapped with domestic waste at the end of its life cycle. We call your attention to the crucial role played by the consumer in the re-use, recycling and other forms of recovery of such waste.

The appliance must be scrapped by a sorted waste disposal centre or by returning it to the retailer (no charge is levied for this service), when you purchase a new equivalent appliance.

Sorted disposal of electric and electronic equipment prevents the negative effects on the environment and human health resulting from improper scrapping, and also allows the materials from which it is made to be recovered and recycled, with significant savings in terms of energy and resources.

The sorted disposal requirement is indicated by the crossed waste bin label affixed to the appliance.



improve your life

www.argoclima.com